

It doesn't take much effort to discover a new place or pastime in Japan. If you are looking to explore something new outside of Tokyo, Hakone or Kamakura would be a great option. A short, scenic railway journey would take you to dozens of sightseeing spots and fun attractions. It's easy to get out of the city and into the fresh air. Admire the natural greenery on a ropeway ride or the picturesque lake by cruise — both highly recommended!

For this trip, I chose to use Odakyu's "Hakone Kamakura Pass" as it offers unlimited railway rides that are under the Odakyu Group in Hakone, Kamakura and Enoshima area for three days. Plus, you may also receive special discounts by showing your pass at specific tourism facilities. I find this pass is convenient and helpful for it saves me both money and time.

Hello, from
HAKONE
And
KAMAKURA
via Odakyu Electric Railway

Unlimited Rides
with
Hakone Kamakura Pass



Writer: Katalaya Pinyo...A travel writer for KIJ Magazine & Website, Katalaya Pinyo is into independent bookstores and chic cafés, especially those designed with a palette of earth tones. She is also in love with traveling in Japan. Follow her on Instagram: @bobokp
*KIJ is an online media and publication dedicated to featuring travel content in Japan, from Japanese food to art. A popular read in Thailand.



OUR THREE-DAY TRIP

with Hakone Kamakura Pass

Day 01

Anyone can easily fall in love with Hakone

My exciting trip started in the outskirts of the Kanagawa Prefecture: Hakone. Located not far from Tokyo, Hakone is only around 80 minutes from Shinjuku Station. Hakone is a leafy town of abundant nature, where you can be in contact with the natural environment. Aside from the tranquil Lake Ashi and lush green valleys, there are also scenic spots where the Mt. Fuji can be seen.

Odakyu Electric Railway

The Odakyu Electric Railway is the best mode of transportation for those who would like to depart from Shinjuku Station. The railway connects you to many tourist attractions in Kanagawa, including Hakone, Kamakura (Enoden Line), Enoshima

Hakone Kamakura Pass



¥ 7000 (adult), ¥ 2250 (child)

3 days

www.odakyu.jp/english/passes/hakone_kamakura



Hakone-jinja Shrine

At the foot of Lake Ashi, you will find a large red torii gate that leads you to the Shinto shrine. You may have seen images of its signature bright gate on the shores of the Internet before. Once I got to Hakone, I took the bus to visit this shrine first. Although it was a little crowded, I felt calm and relaxed at the sight of it.

🚌 Motohakone (Hakone Tozan Bus)

Yunessun

Yunessun is an amusement park with indoor and outdoor hot spring baths in Hakone. There are 23 kinds of relaxing hot spring baths that you can enjoy. While you can relax in open-air baths with stunning views, there are also unique baths of wine, coffee, green tea, Japanese sake and so much more. It's a great hot spring destination that suits all ages, you can wear your swimsuit, too.



🚌 Take the Hakone Tozan bus and get off at the Kowakien bus stop.





🌐 www.yunessun.com/global/en/



By holding the Hakone Kamakura Pass, you can also enjoy scenic bus rides, sightseeing cruises and ropeway rides. I chose to take a cruise from the port of Moto-Hakone to the port of Togendai and then switch to Hakone Ropeway before proceeding to Owakudani Valley.

Hakone Ropeway

A relaxing ride, the ropeway takes you to see Hakone at a height of 1,000 meters. It does not only connect the stations of Togendai and Sounzan, but you may also get off at any of the stations on the way. From the Ropeway, you will be impressed by the beautiful colored foliage in autumn and Mt. Fuji against the cerulean sky whenever you visit.

-  Togendai-ko (Hakone Sightseeing Cruise)
-  Togendai (Hakone Tozan Bus, Odakyu Hakone Highway Bus)
-  Sounzan (Hakone Tozan Cable Car)
-  www.hakoneropeway.co.jp/foreign/en/



Owakudani

When you reach Owakudani, one of the active volcanoes in Japan, you will notice the smell of sulfur and see steam from afar. The Owakudani Valley is famous for serving kuro-tamago, or black

eggs, which are eggs boiled in the hot mineral waters of the area. The sulfur in the water gives the eggshells its black exterior. The locals believe that, by eating a black egg, you add seven years of life expectancy. I ate three, so I will probably live longer and visit Japan many more times.





 Owakudani (Hakone Ropeway)

Lake Ashi

Formed after the eruption of Mt. Hakone, Lake Ashi is surrounded by mountains of forests that change colors every season. Mt. Fuji can be seen anywhere when you wander around the lake or on the sightseeing cruise. No matter who you are, you will likely fall in love with this place.



 Motohakone-ko, Hakonemachi-ko, Togendai-ko (Hakone Sightseeing Cruise)
 www.hakone-kankosen.co.jp/foreign/en

Hakone Sightseeing Cruise



You can hop on this scenic cruise and tour around the picturesque lake at the port of Moto-Hakone and Togendai. Every one-way trip takes about 30 minutes. There is plenty of food, beverages and souvenirs sold on the cruise, too.



Day 02
today is Hakone Day

I am still in Hakone because there are just so many interesting things I have yet to discover. Not only do I find the diversity of natural and cultural attractions intriguing, but the special way of life also stirs my curiosity. For that reason, I decided to stay in Hakone a little longer.



The Naraya Café is a bakery, as well as an art gallery. The view of Hakone from here is just excellent. There is a footbath free-of-charge, too.

- 🕒 10:30-18:00
- 🗓️ Wed, 4th Thu of the month
- 📍 Miyanoshita (Hakone Tozan Cable Car, Hakone Tozan Bus)
- 🌐 naraya-cafe.com

Miyanoshita Station

What a cute train station! I think Miyanoshita is a chic area that gathers a collection of stylish bakeries, cafés and zakka* shops. The shopfronts may not be extravagantly decorated but they still draw me into explore more. It was an enjoyable walk. If you are looking for a cool area to wander around, I highly recommend Miyanoshita Station. There are also small shrines and interesting museums for you to check out.



There is a store in the Ajsai-zaka slope area that sells a variety of cute zakka*.

*Zakka: miscellaneous goods to improve one's home, life and appearance.

Gotemba Premium Outlets®

📍 Gotemba Premium Outlets®
 (Hakone Tozan Bus)
 🌐 www.premiumoutlets.co.jp/en/

Gotemba, Japan's first premium outlets, houses more than 200 popular brand stores. For the ease and convenience of shoppers, Gotemba is divided into two zones by the different valleys. The outlets are connected by bridges, from west to east. It has already opened a new hill side in June 2020, showcasing up to 290 shops in total. If weather permits, you will also see Mt. Fuji towering in the background, making the shopping experience even more worthwhile.









Mishima Skywalk

The longest suspension bridge in Japan, the Mishima Skywalk boasts a length of 400 meters that stretches across the valley 70 meters above the ground. This place is another great spot to observe Mt. Fuji. As the skywalk is supported by sturdy steel that helps reduce the wind force, it's unlikely you'll feel the butterflies in your stomach. The skywalk is much wider than normal bridges, allowing visitors with wheelchairs to see the 360° views without the fear of inconvenience. Aside from the lovely skywalk, there are also other activities such as ziplining, food market strolling, greenhouse visiting, café hopping and wandering through the Kicoro trails.



 Mishima Skywalk (Tokai Bus)
 www.mishima-skywalk.jp



 Gotemba Premium Outlets (Hakone Tozan Bus)
 www.gotemba-hotelclad.jp/en/

HOTEL CLAD

This is the new hotel located within Gotemba Premium Outlets®, the largest outlet mall in Japan. HOTEL CLAD provides a comfortable stay as well as relaxing natural hot spring baths. More than half of the hotel guestrooms offer breathtaking views of Mt. Fuji, too. Wouldn't it be great if you could go shopping and then retreat to a relaxing stay at the end of the day?

Day 03

Kamakura is calling for you.



©鎌倉市観光協会

Kamakura-kokomae

I believe that many of you may recognize this particular scene where there is a train intersection against a blue backdrop of the clear sky and sparkling sea as it is often featured as a destination in animated movies. If timing is good, you may catch the sight of the green Enoden train. The Kamakura-kokomae Station is not that far, so you can probably walk there. While it is not so crowded on weekdays, it can get pretty busy on weekends.

📍 Kamakura-kokomae (Enoden)

No matter where I go,
I want to see **the sun**



On the next day, I traveled from Hakone to a town called Kamakura that embodies hundreds of years of history. The atmosphere of this old town exudes Japanese traditional culture. While Kamakura is nestled by the shores, it also boasts mountain views, which adds to the slow pace of life. If you have extra time, I would like to suggest checking out the different places and sampling tasty bites in Kamakura.

Komachi-dori Street



Situated in the heart of the old town, Komachi-dori Street is not far from Kamakura Station. There is an array of stores here, including restaurants, souvenir shops, lovely cafés, bookstores and handcraft stores. I spent more than half a day, simply wandering around.



📍 Kamakura (Enoden)



Kotoku-in Temple

In this ancient town of Kamakura, there are a number of temples and shrines. Kotoku-in Temple is a famous one that houses the green bronze statue of the Great Buddha of Kamakura. Recognized as one of the many national treasures of Japan, Kotoku-in attracts plenty of tourists.

📍 Hase (Enoden)

Simple Eats in Kamakura

If you enjoy trying new foodstuffs,
head to any of these places for a nice meal at Kamakura.

Kannon Coffee

One of the many branches of the famous coffee shop originated from Nagoya, Kannon Coffee does not only have good coffee. I would recommend their Daibutsu Crêpe, which includes seasonal fruits and yogurt. It is only sold at this particular Kamakura branch. Don't forget to order the daibutsu buddha cookie as well.



🕒 10:00-18:00
📍 -
🌐 kannon-coffee-kamakura.business.site
📍 Hase (Enoden)



Mushin-an



🕒 Fri-Wed 10:00-17:00
📍 Thu
🌐 mushinan.chobi.net
📍 Wadzuka (Enoden)

Located within a hundred-year-old Japanese wooden house by the railroad, Mushin-an showcases a series of Japanese sweets and more. My favorite would be the Fruit Yogurt, which is simple yet delicious. The location is also very convenient as it is only a few steps away from the station.

Oxymoron Komachi

A nice curry restaurant that turns the freshest ingredients into novel flavor combinations. The menu makes me want to try every single dish. Aside from popular curry creations, the desserts just as tempting and delicious. By the way, the shop is always crowded, so expect to queue up if you want to try it.



🕒 Thu-Tue 11:00-18:00
📍 Wed
🌐 www.oxymoron.jp
📍 Kamakura (Enoden)



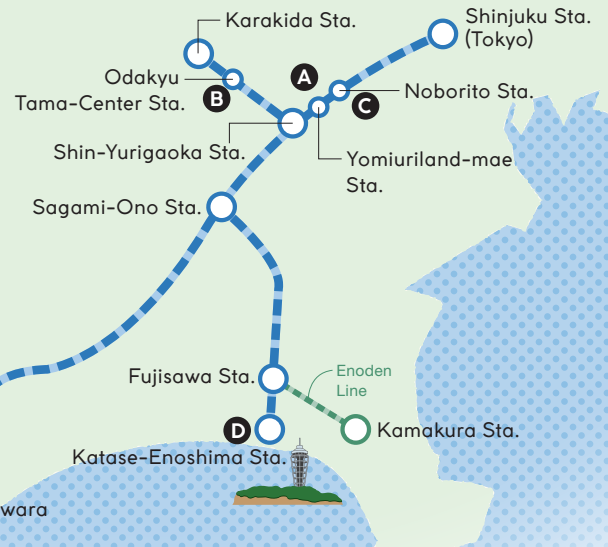

ATTRACTIONS

Along the Odakyu Line

A Yomiuri Land

Are you looking for fun attractions? You can dive into a new adventure at Tokyo's largest amusement park, Yomiuri Land. From thrilling rollercoasters to family-friendly rides, Yomiuri Land does not



only feature a number of exciting activities but it also hosts a range of events throughout the year. Expect a splash of fun in the pool during summer and illumination celebrations in the winter. This is a must-visit!

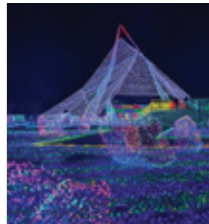

Approx. 10 minutes by bus from the Yomiuri-Land-mae Station www.yomiuriland.com/en/

B Sanrio Puroland

Meet Hello Kitty and her friends, who are beloved characters in the world of Sanrio Puroland. This is an indoor theme park in Tama city of Tokyo. This is a fun attraction for all ages. This would be a great activity, especially on rainy days.



Odakyu Tama Center station
en.puroland.jp/



©'13,'20 SANRIO S/D G
©'76,'90,'96,'99,'01,'10,'20 SANRIO APPROVAL No.P1103241

C Fujiko·F·Fujio Museum

Situated in Kawasaki of Kanagawa Prefecture, Fujiko·F·Fujio Museum honors the creator of Doraemon, Fujiko·F·Fujio. The museum features a range of facilities from exhibition halls and a theater room to a manga corner and a rooftop playground, all showcasing the works of Fujio. There is also a café and souvenir shop where you can rest and shop. You'll likely fill your heart with Doraemon's dreams and be fuelled with his miracles after the visit!

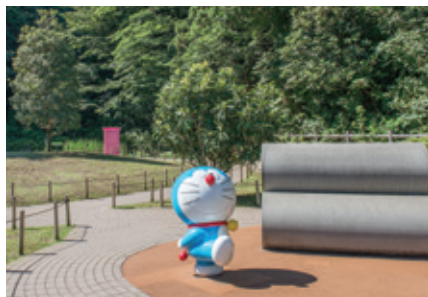

©Fujiko-Pro•2011 Fujiko-Museum

Approx. 9 minutes by bus from the Noborito Station fujiko-museum.com/english/

D Enoshima Aquarium

This is a good place to visit when you are traveling in Enoshima. This modern aquarium lets you enjoy dolphin and sea lion shows against the beautiful backdrop of the shimmering ocean.



Plus, there are other aquatic attractions including deep water fish, arctic penguins, rare jellyfish and much more.

Approx. 3 minutes on foot from the Katase-Enoshima station www.enosui.com/en/

